

충무로역 등 8역 편의시설(엘리베이터) 설치공사

설 계 도

2021. 1.



서울교통공사
Seoul Metro

도 면 목 차

도면명칭	도면번호	비 고
청량리역 출입구 #2 외부 E/L 구조 일반도	A-001	
용답역 내부 E/L 구조 일반도	A-020	
용답역 내부 E/L 승강장층 평면도	A-021	
영등포구청(2)역 출입구 #5 외부 E/L 구조 일반도	A-030	
구로디지털단지역 출입구 #3 외부 E/L 구조 일반도	A-040	
교대(3)역 출입구 #13 외부 E/L 구조 일반도	A-050	
충무로역 내부 E/L 구조 일반도	A-060	
충무로역 내부 E/L 지하 3,4층 평면도	A-061	
명동역 내부 E/L 구조 일반도	A-070	
명동역 내부 E/L 지하 4층 평면도	A-071	
충무로역 환승 E/L 구조 일반도	A-080	

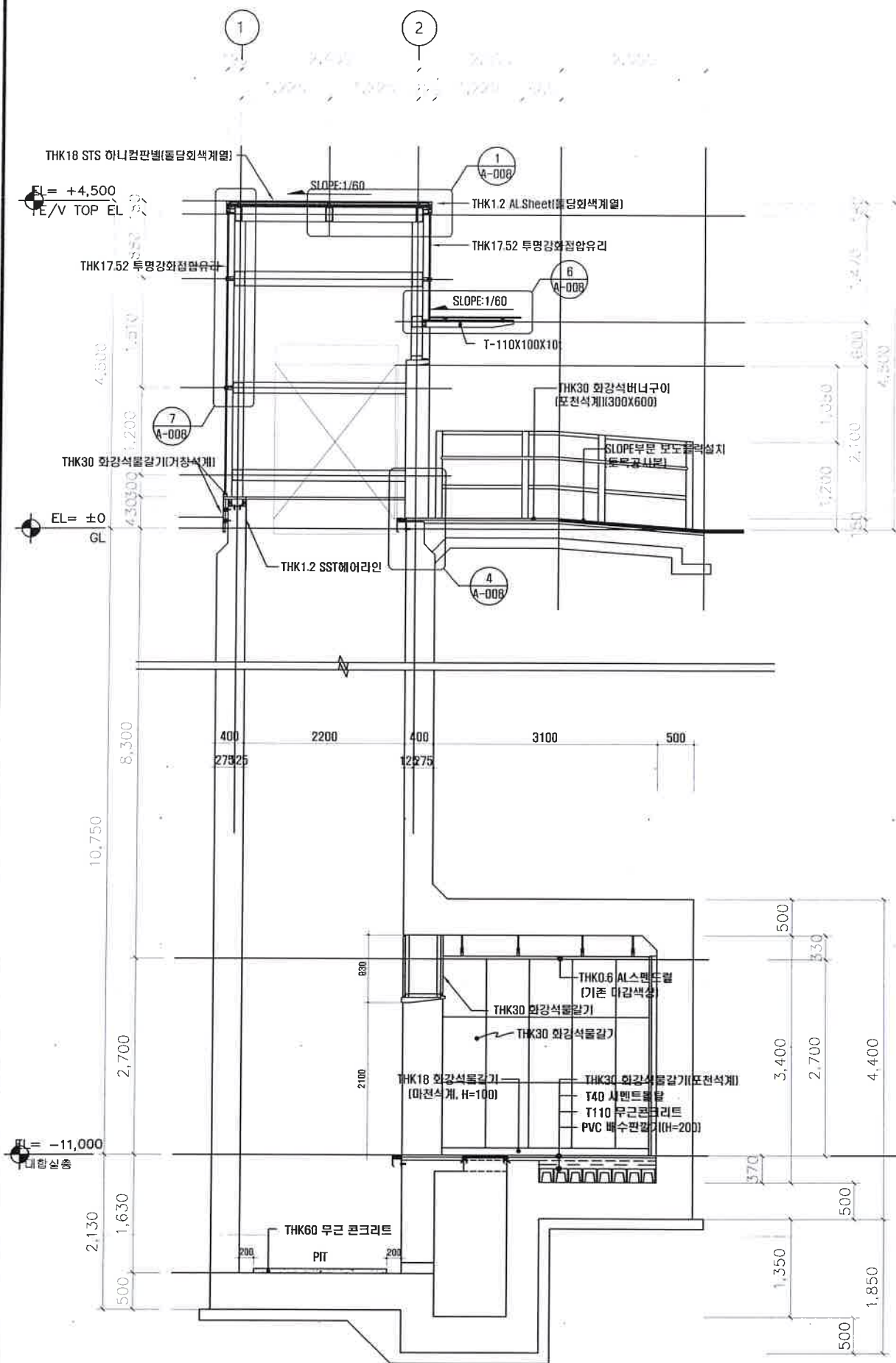

1 외부 E/V 단면도-2
축척 : 1/80

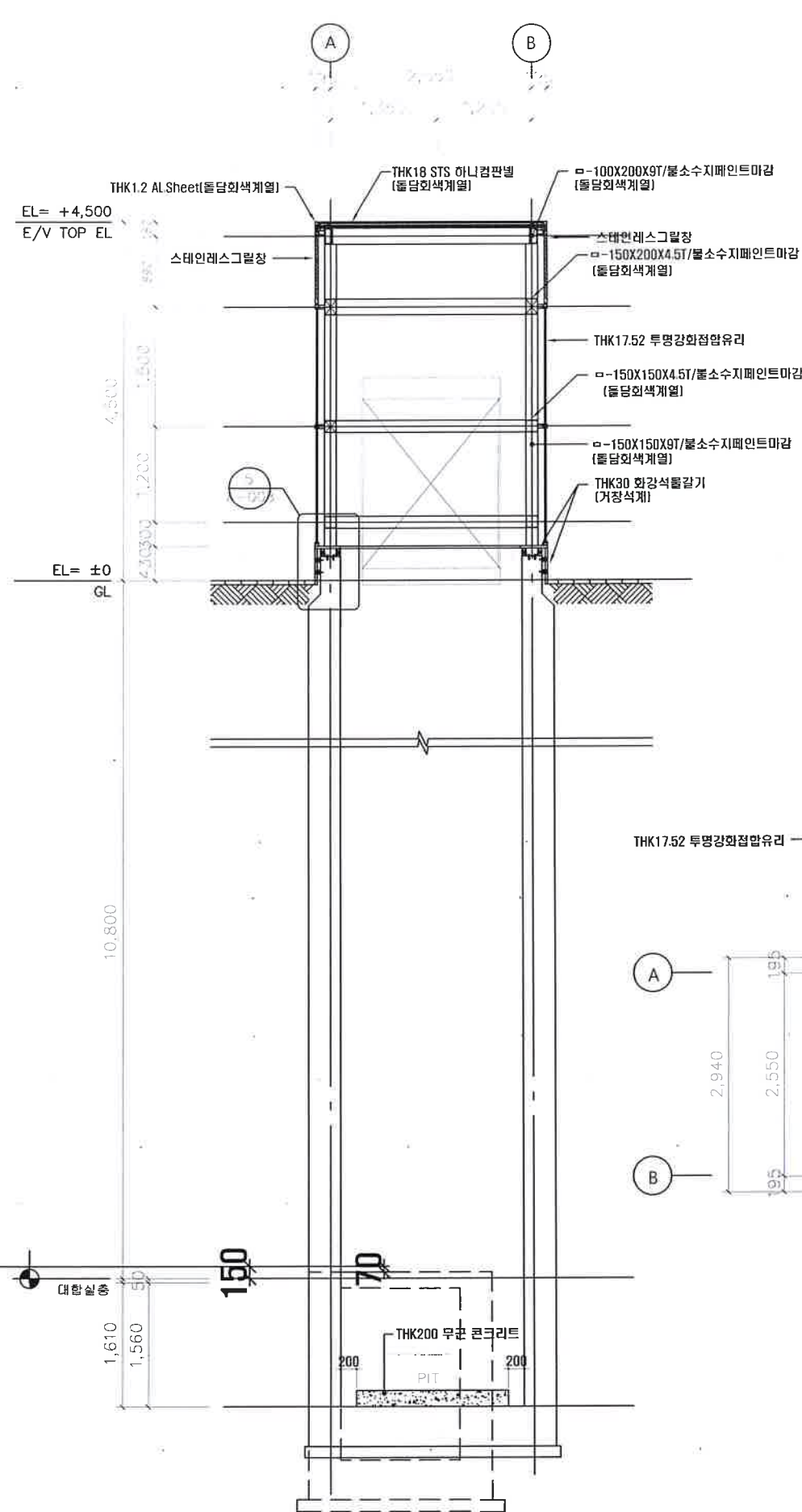

2 외부 E/V 단면도-3
축척 : 1/80

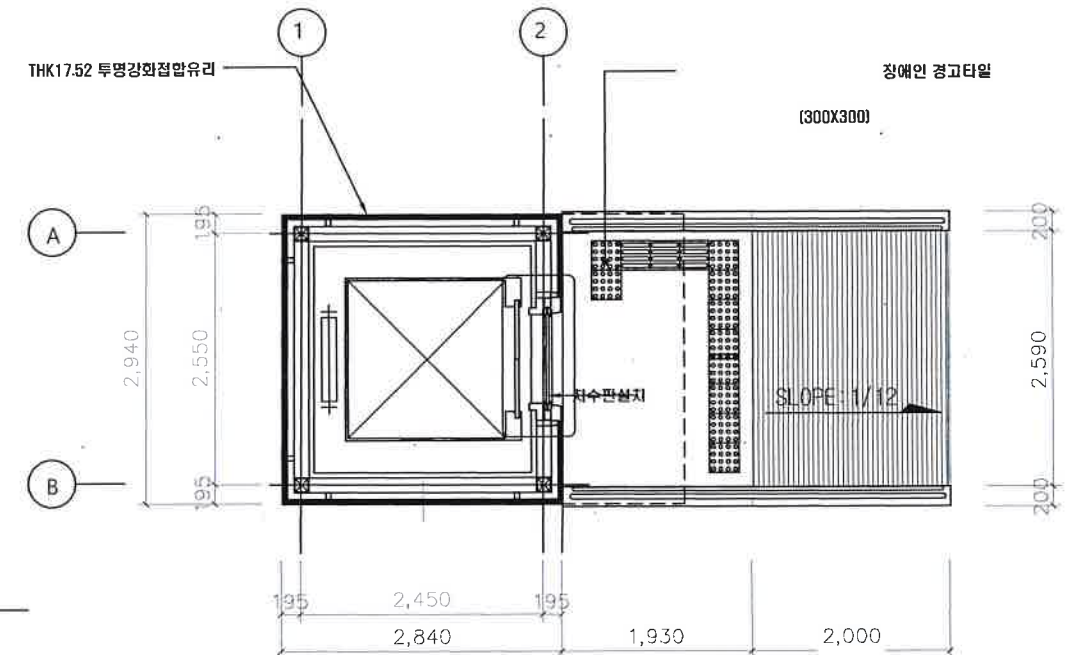

3 외부 E/V 평면도
축척 : 1/80

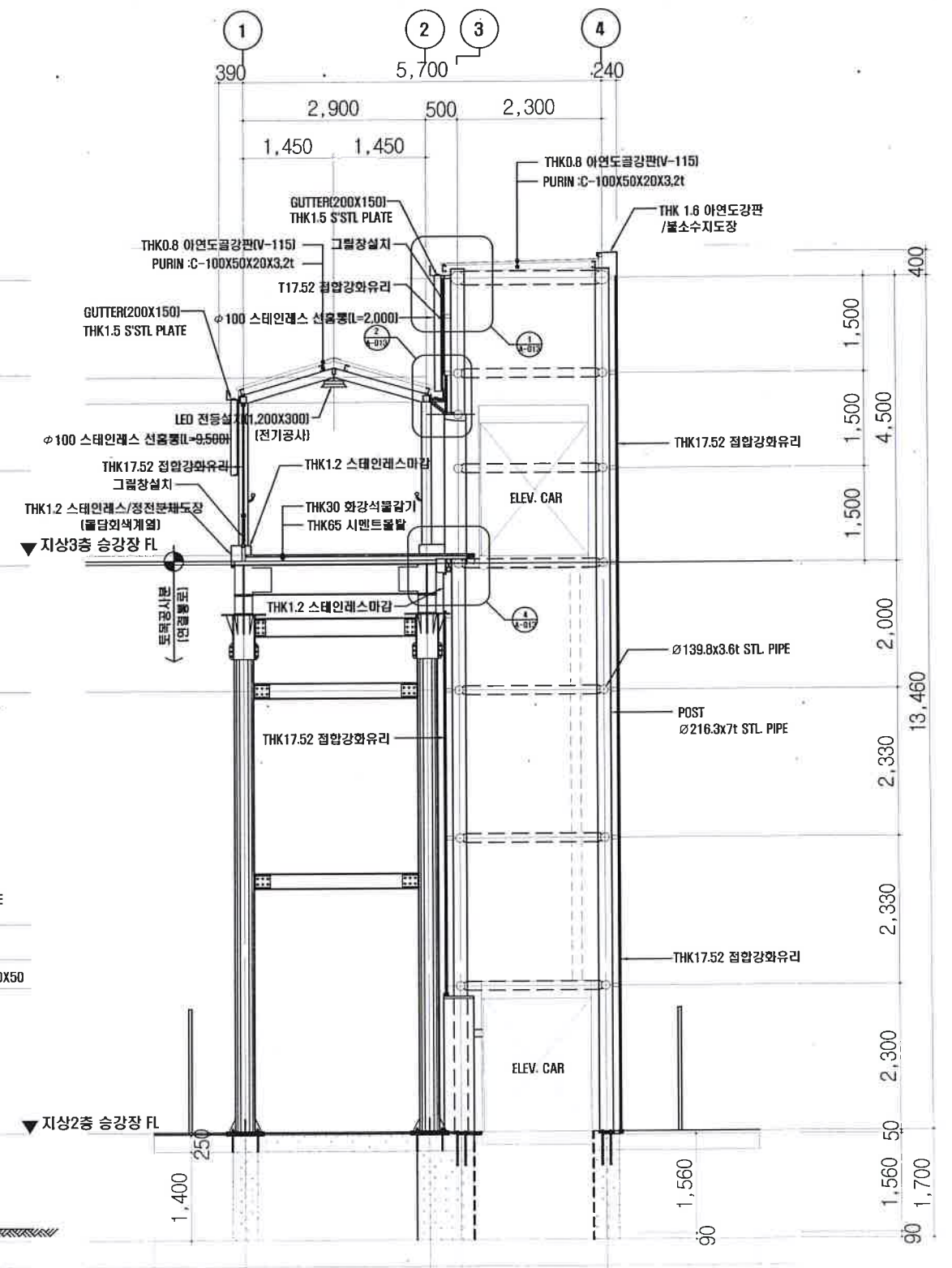
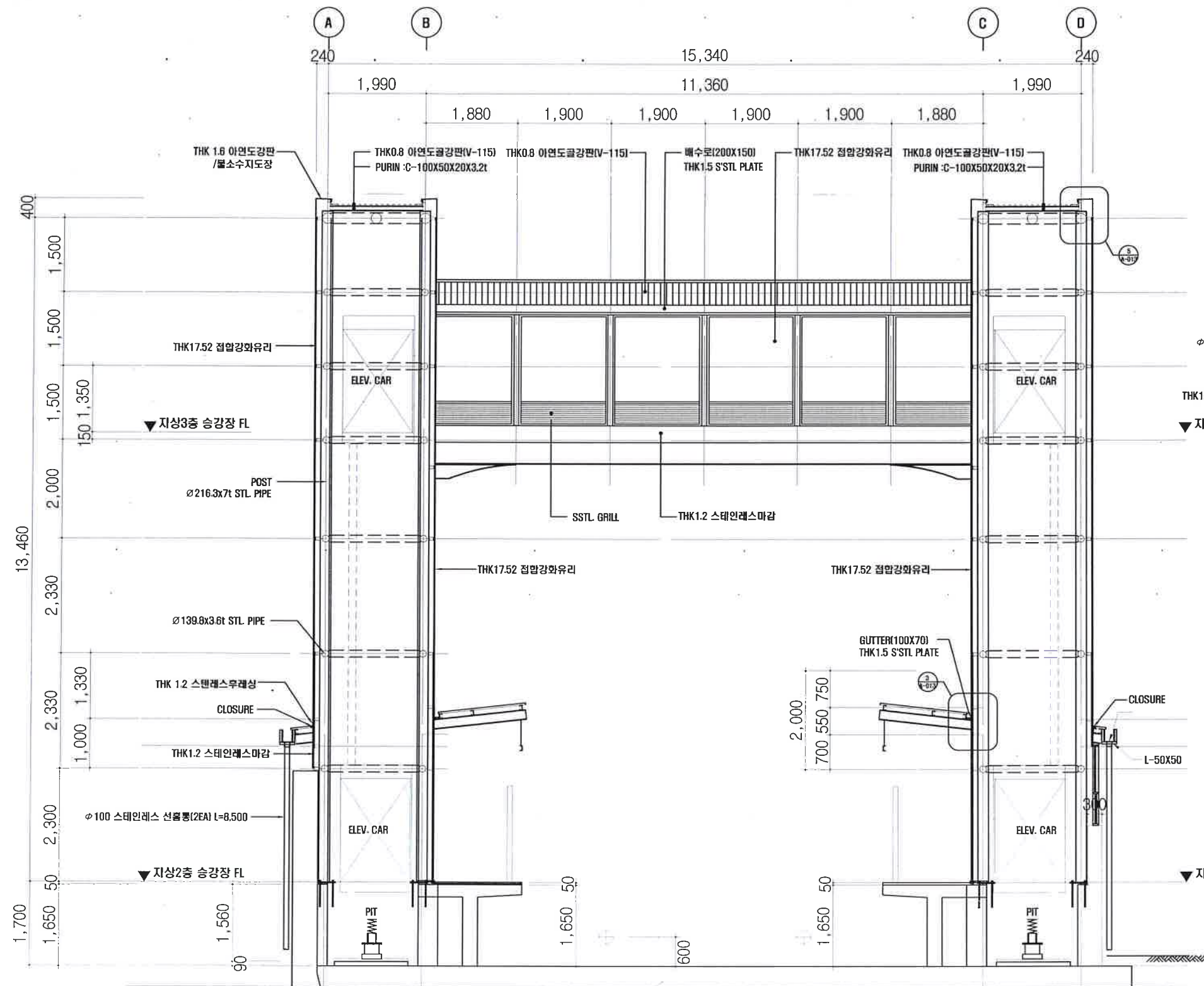

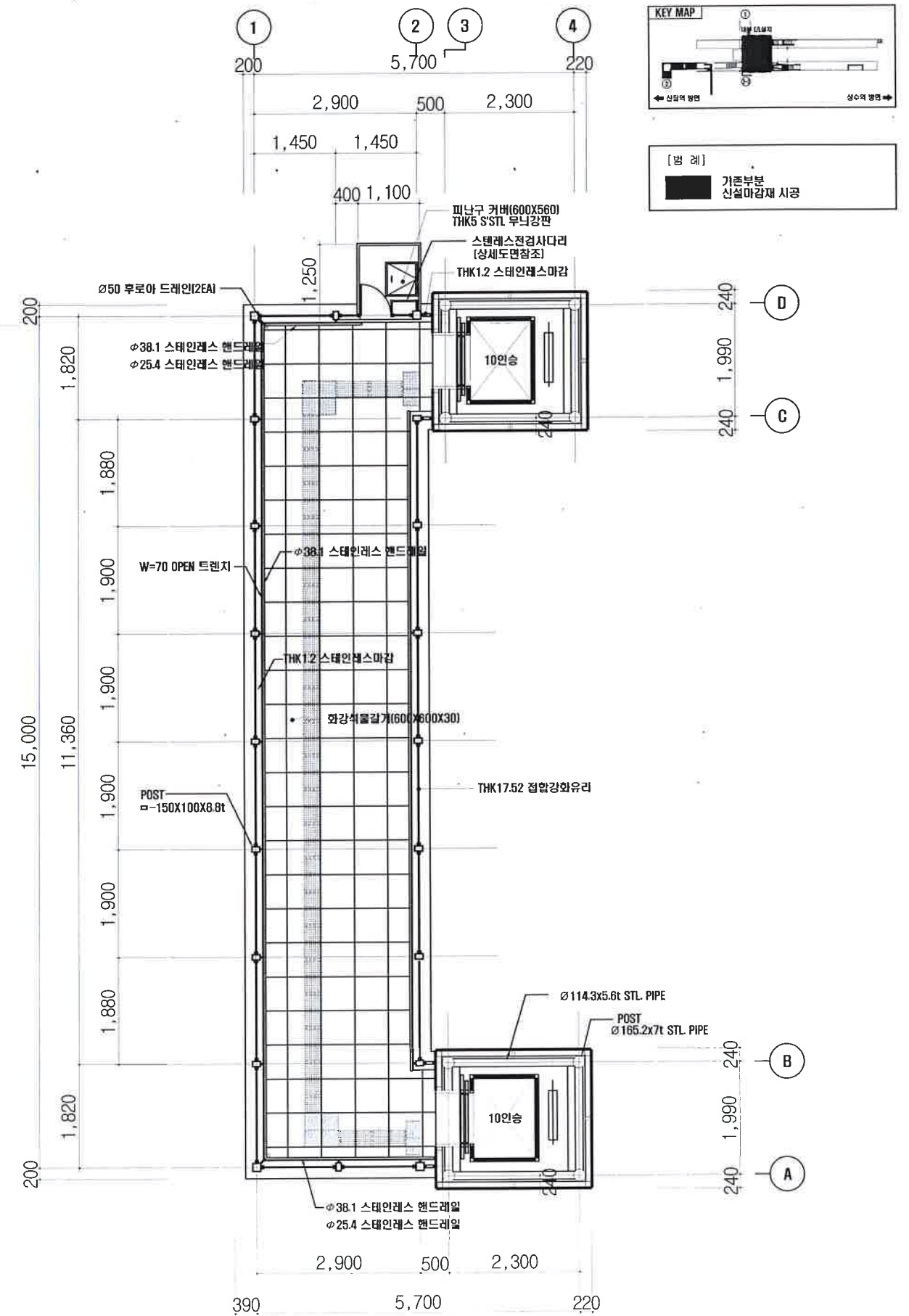

2
A-005

지상3층 평면도(변경후)



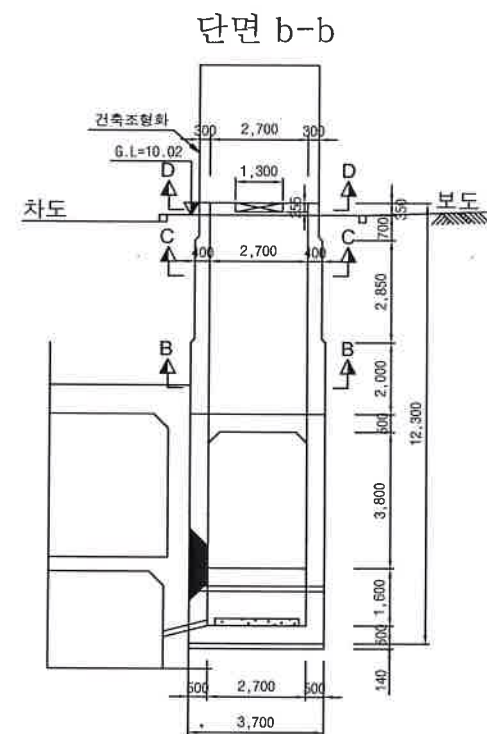
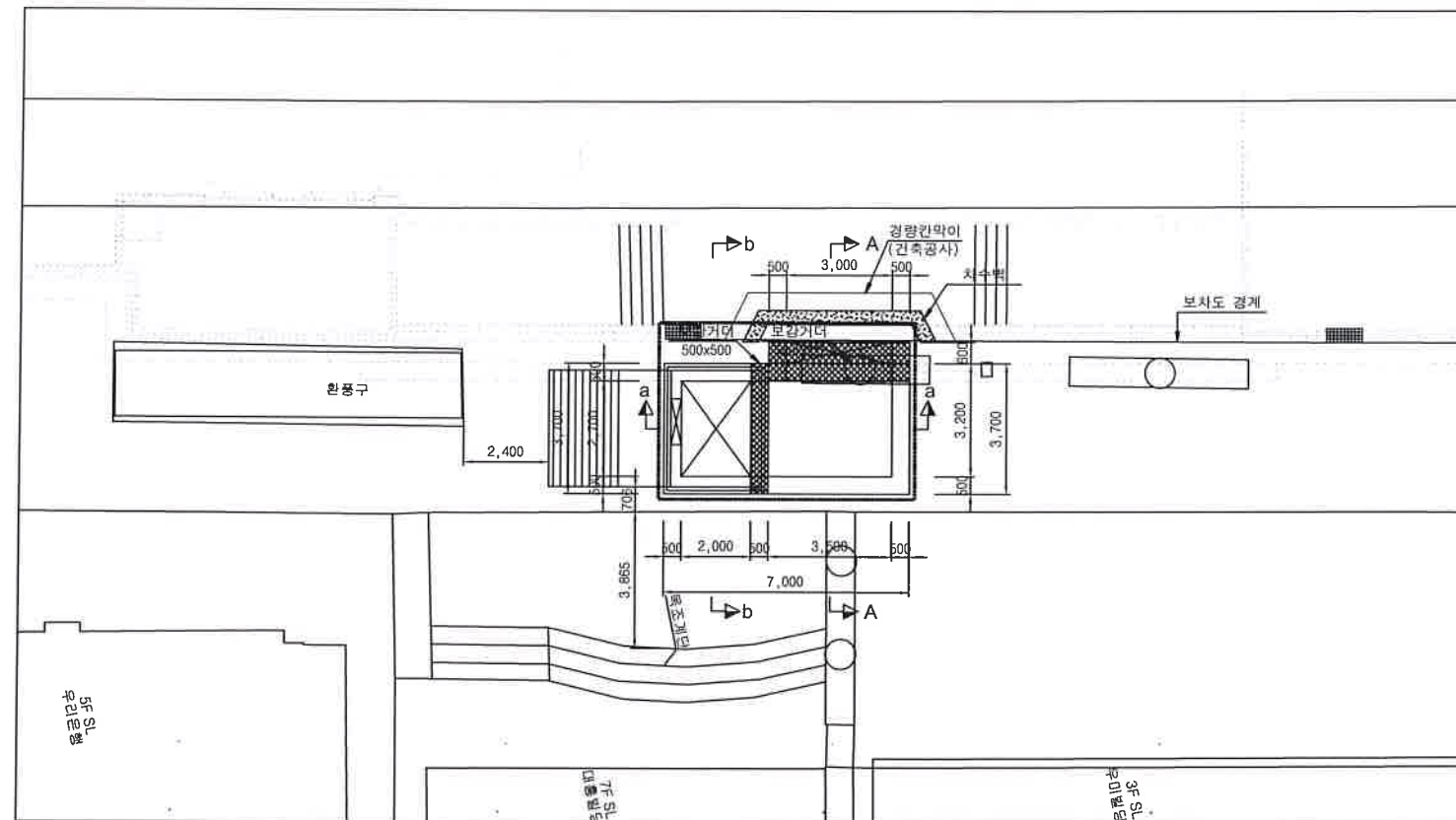
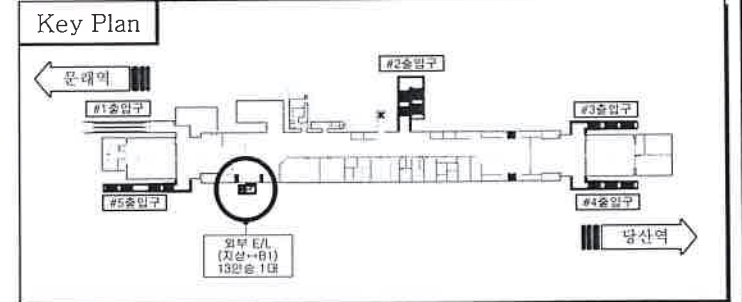

축척 : 1/100

S=1:100

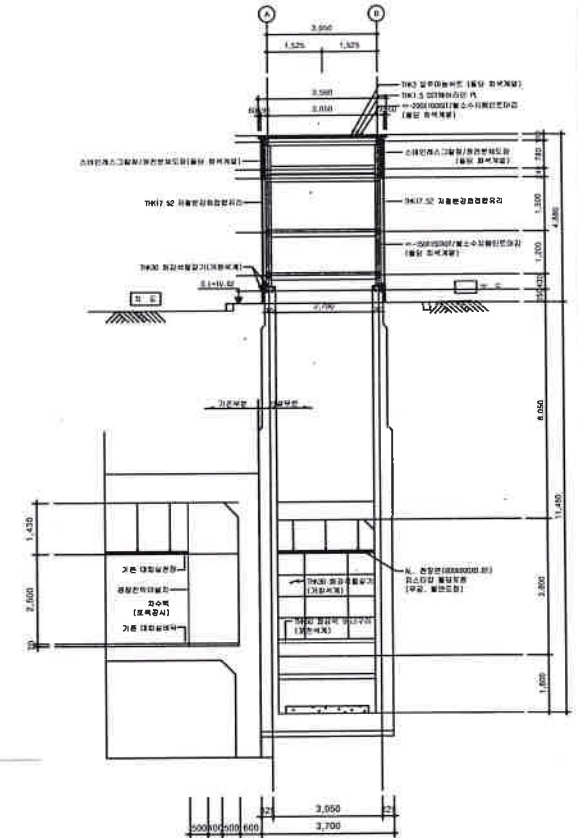
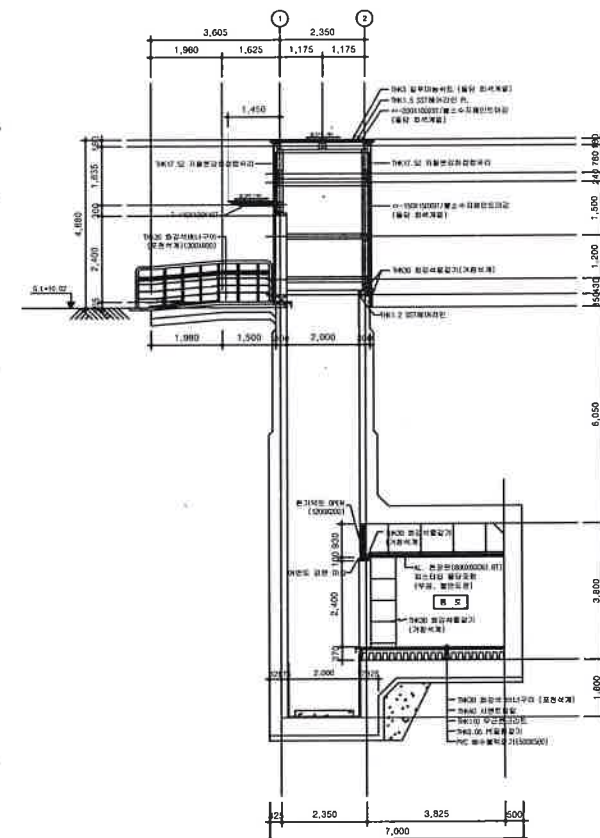
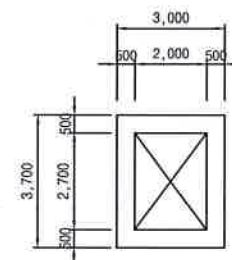

단면 B-B

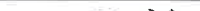

 서울교통공사 Seoul Metro	사업명	지하철1~4호선 승강편의시설 설치 기본 및 실시설계 용역 [3단계 4차]					특기사항	지하철2호선  문래 영등포구청 당산 1:100	도면명 영등포구청(2)역 출입구 #5 외부E/L 구조 일반도		
 (주) 유 신 ENGINEERING CORPORATION	책임 기술자	최성욱 최성욱 검토자 김기림 김기림 설계자 전성준 전성준							일자 2019. 03 일련번호 A-030		
 (주)신성엔지니어링 Shinsung Engineering Consultants Co., Ltd.											

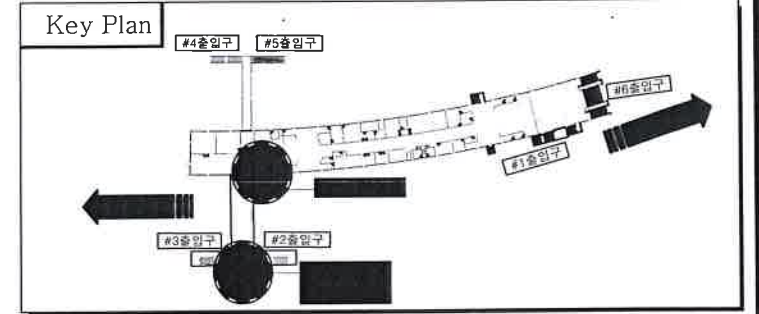

구로디지털단지역 외부E/L 일반도
(E/L 21인승 1대) S=1:100

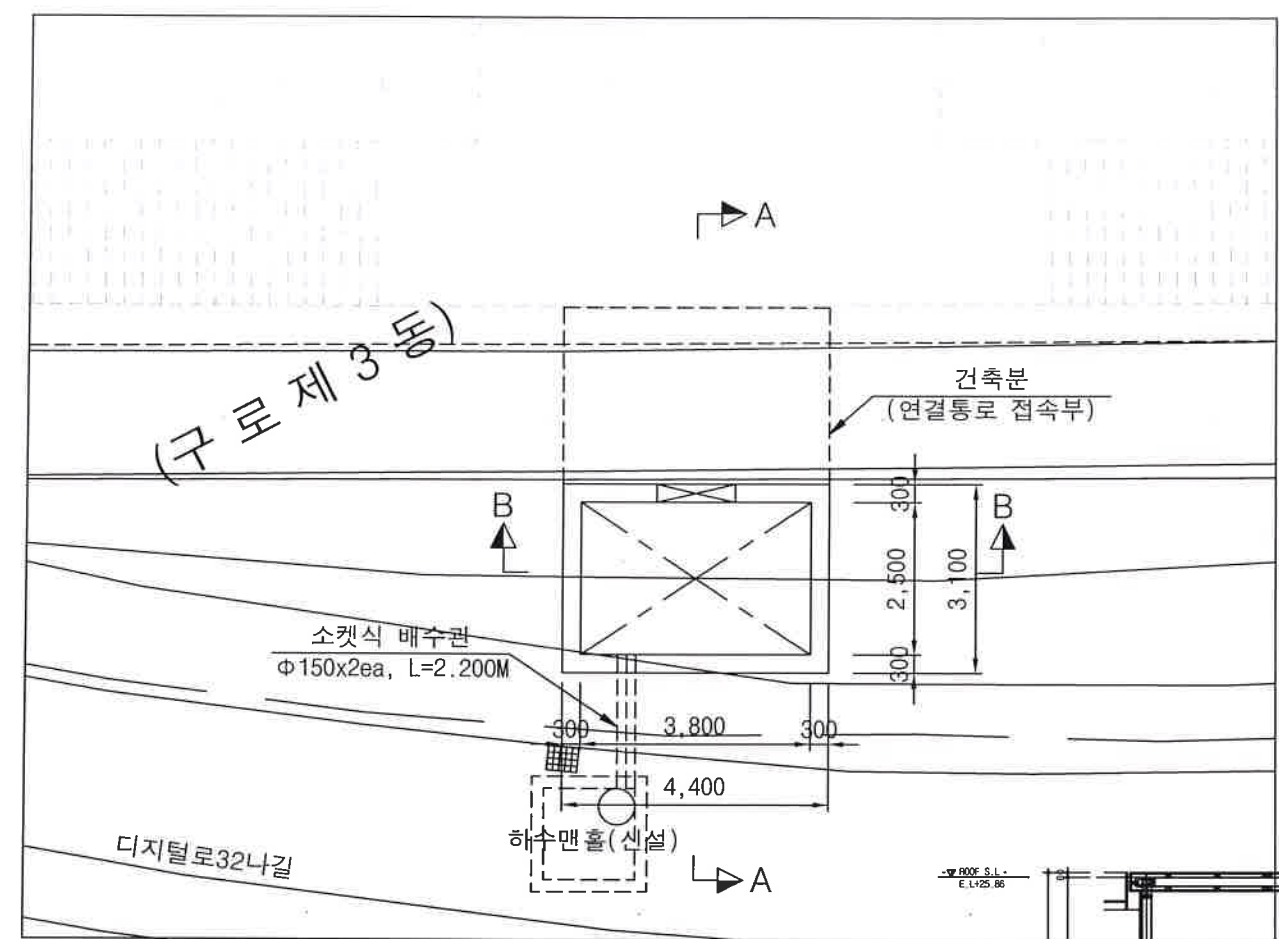

평면도
A-007

1 외부 E/V 단면도-1
A-007

2 외부 E/V 단면도-2
A-007

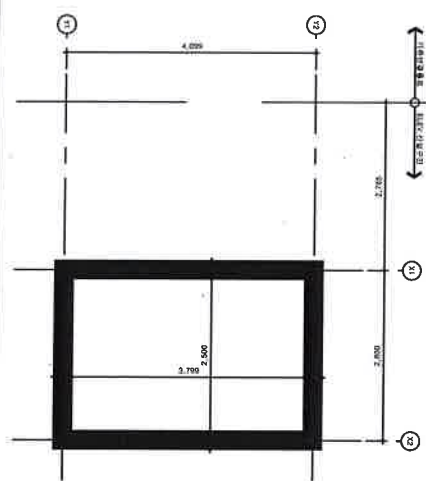
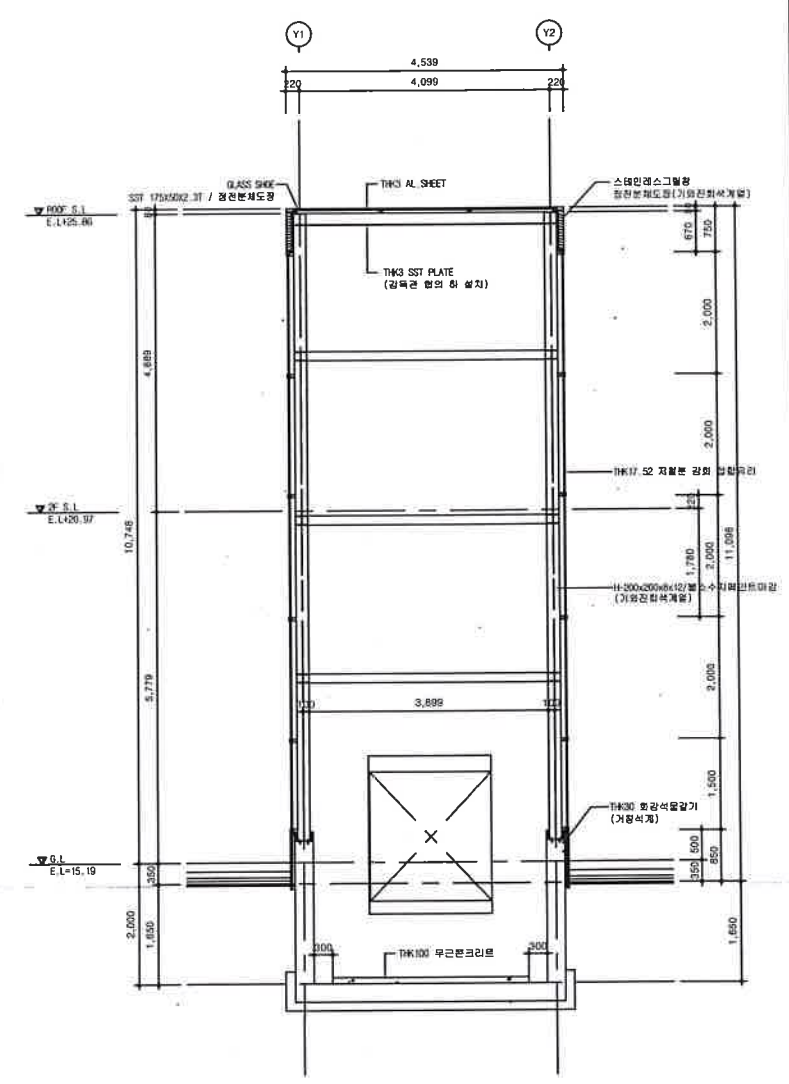
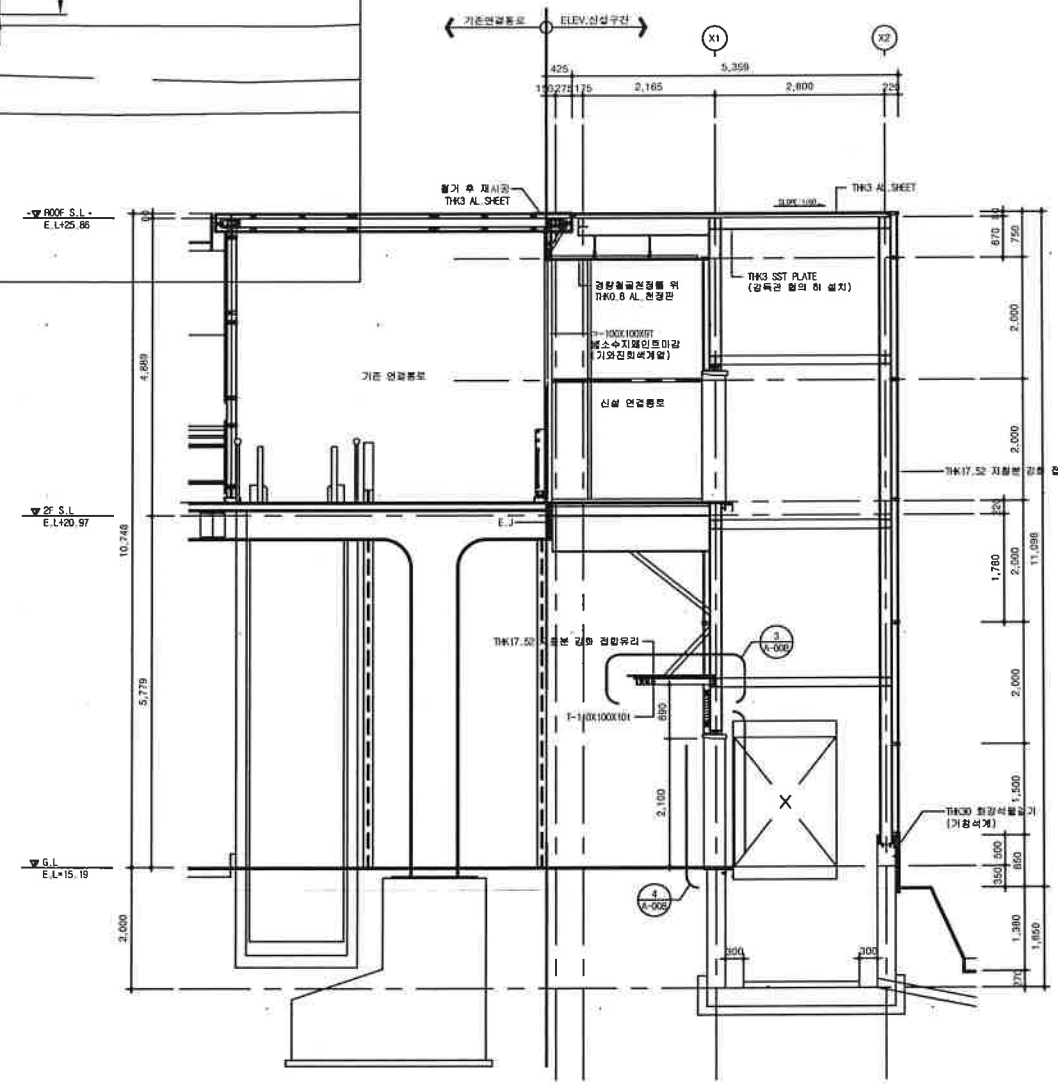

1 PIT층 바닥구조 평면도
A-007

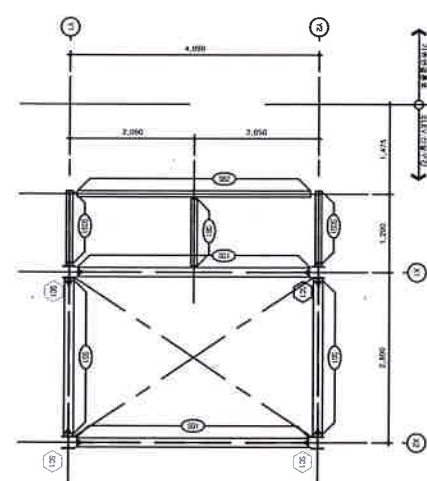

3 1M층 바닥구조 평면도(EL+18.29)
A-007

<p>서울교통공사 Seoul Metro</p> <p>(주) 유 신 ENGINEERING CORPORATION</p> <p>(주) 신성엔지니어링 Shinseung Engineering Consultants Co., Ltd.</p>	<p>사업명</p> <p>책임 기술자</p>	<p>지하철1~4호선 승강편의시설 설치 기본 및 실시설계 용역 (3단계 3차)</p> <p>최성욱 최성욱 검토자 김기림 김기영 설계자 송창원 송창원</p>	<p>특기사항</p>	<p>지하철2호선</p> <p>대림 구로디지털단지신대방</p>	<p>축척</p> <p>1:60</p>	<p>도면명</p> <p>구로디지털단지역 외부E/L 일반도</p> <p>일자 2019. 10. 일련번호 A-40</p>
---	------------------------------	---	-------------	------------------------------------	-----------------------	--

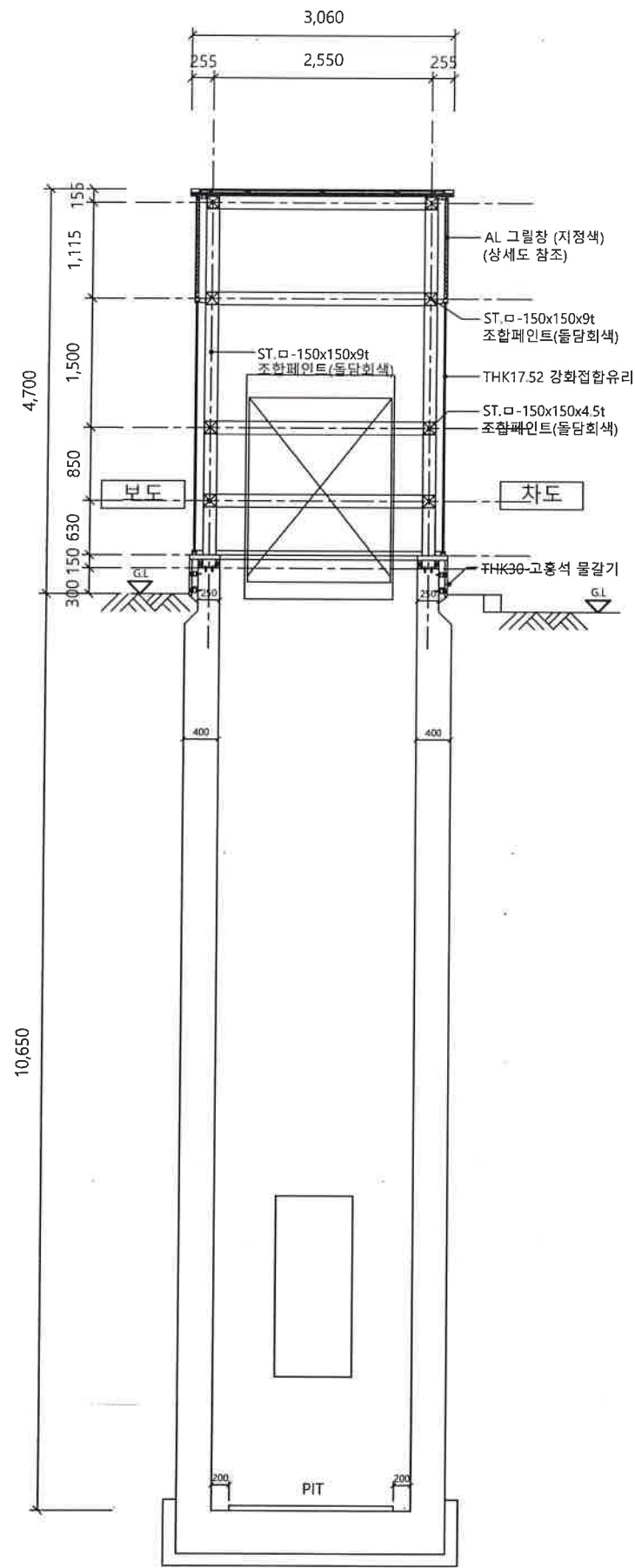

1 종단면도
축척 1/80

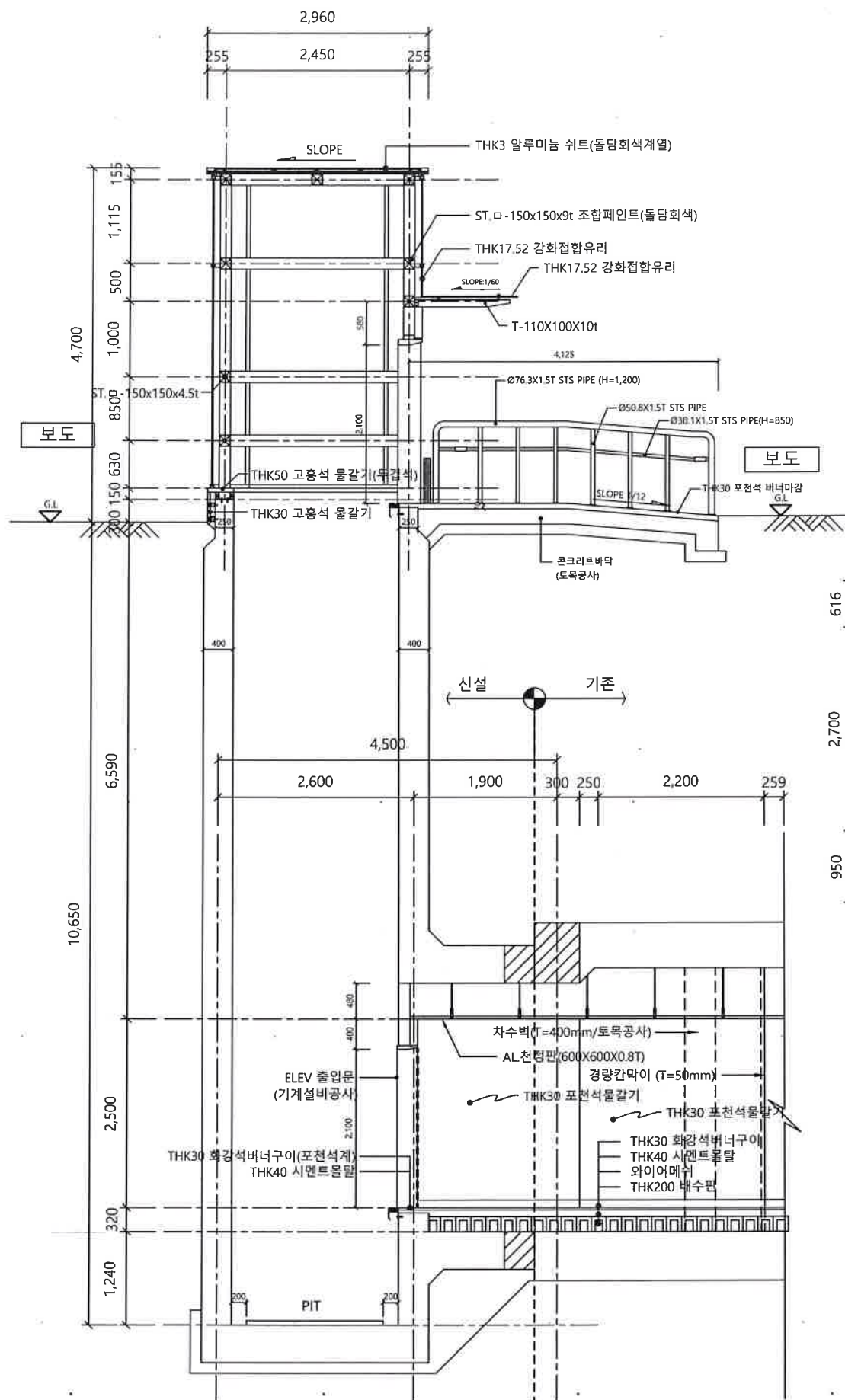

2 횡단면도
축척 1/80

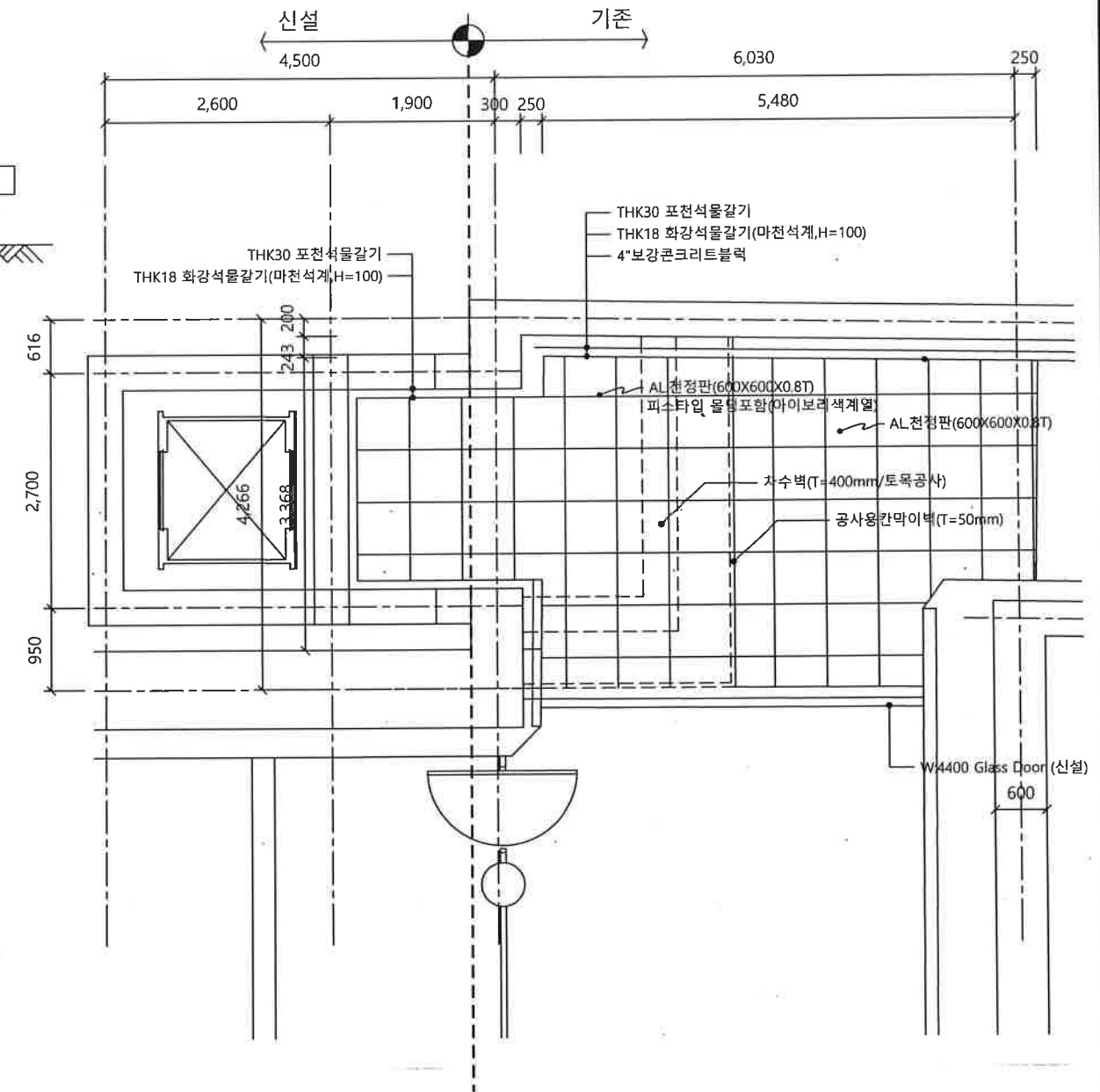
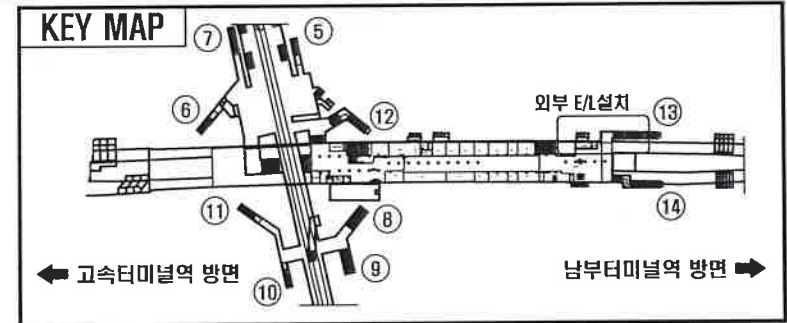

2 지하층 천장평면도(변경후)
축척 1/80

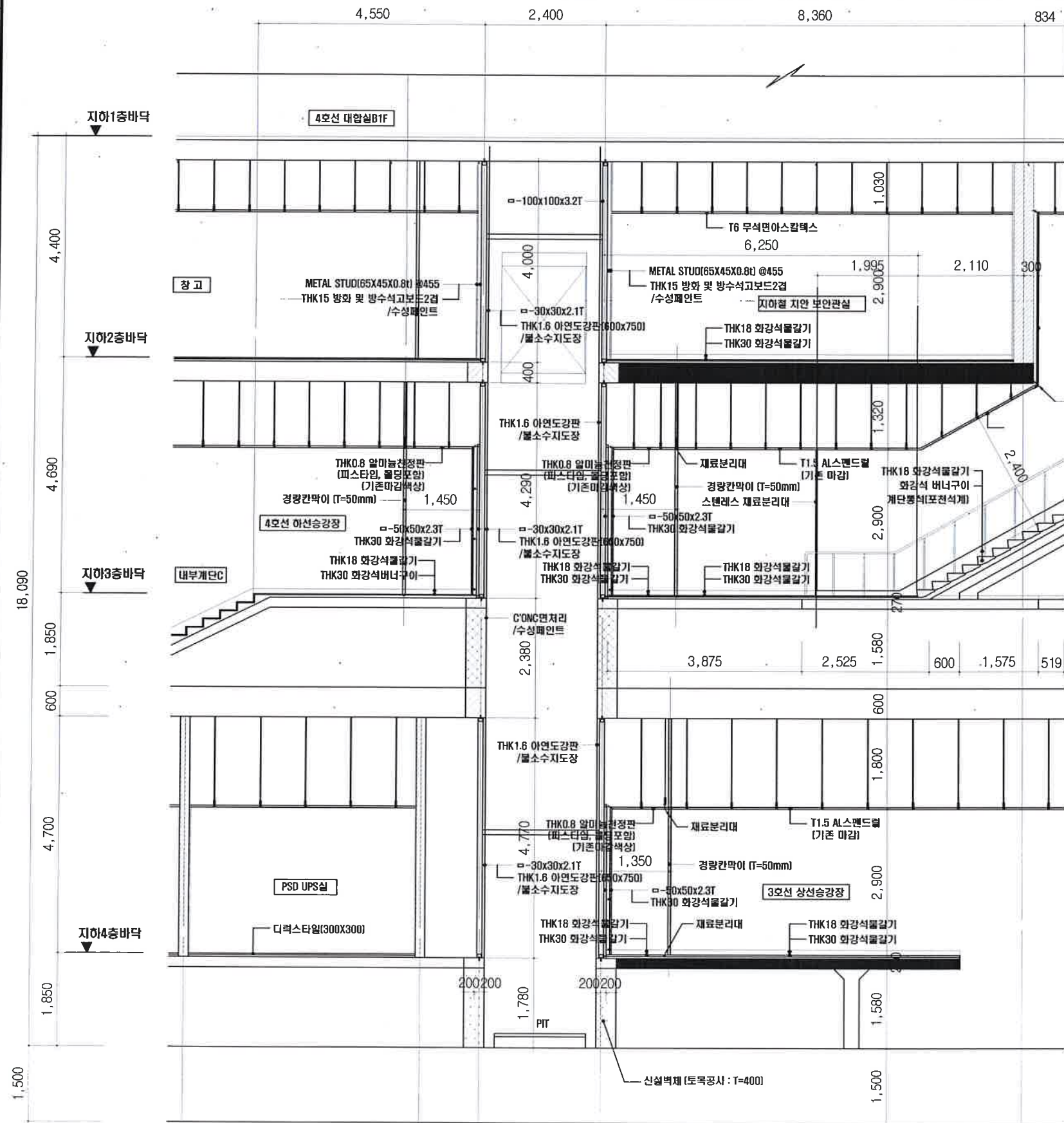

1 단 면 도 - 1
A-012 축척 : 1/100

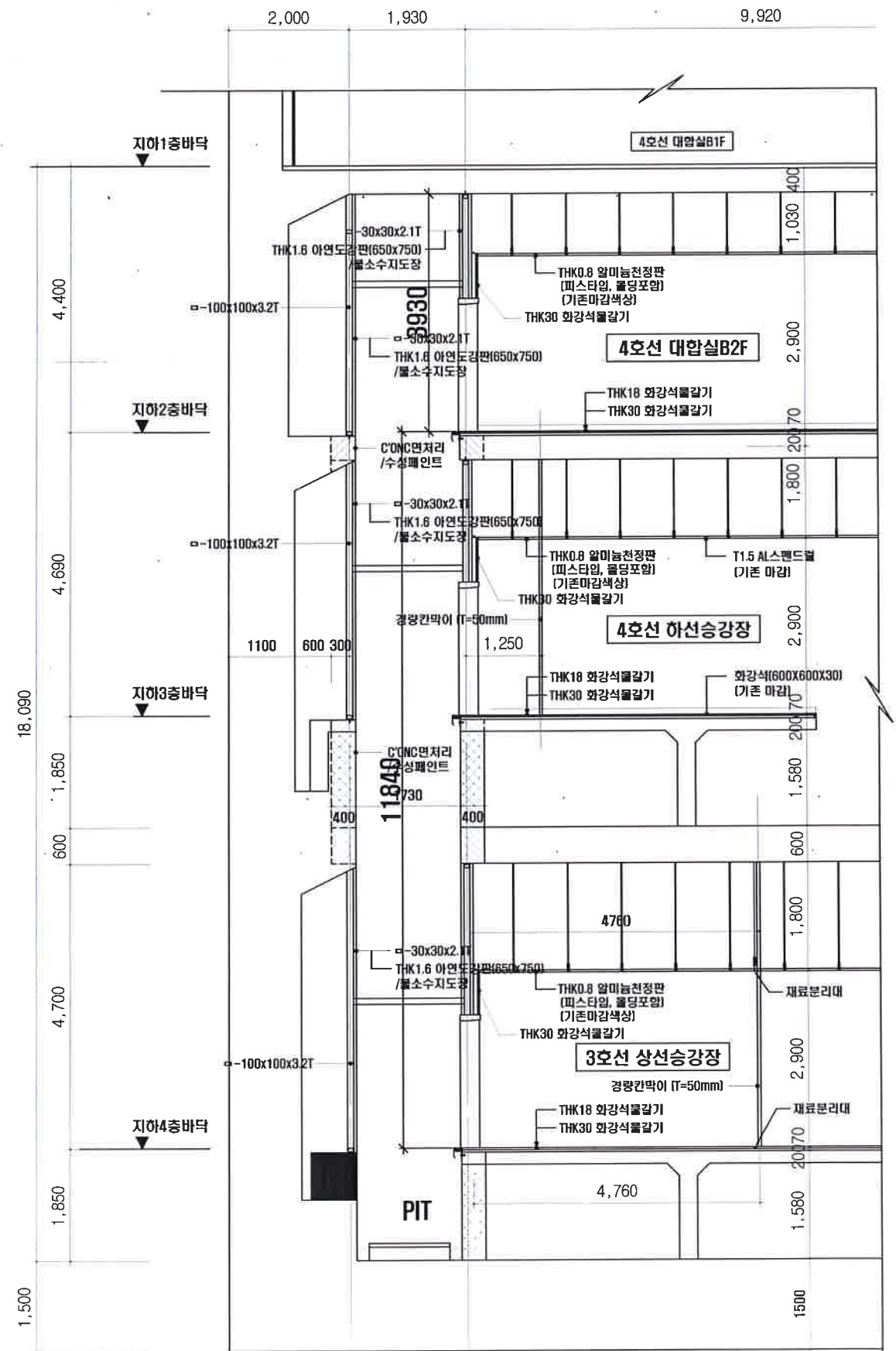

1 단 면 도 - 2
A-013 축척 : 1/100

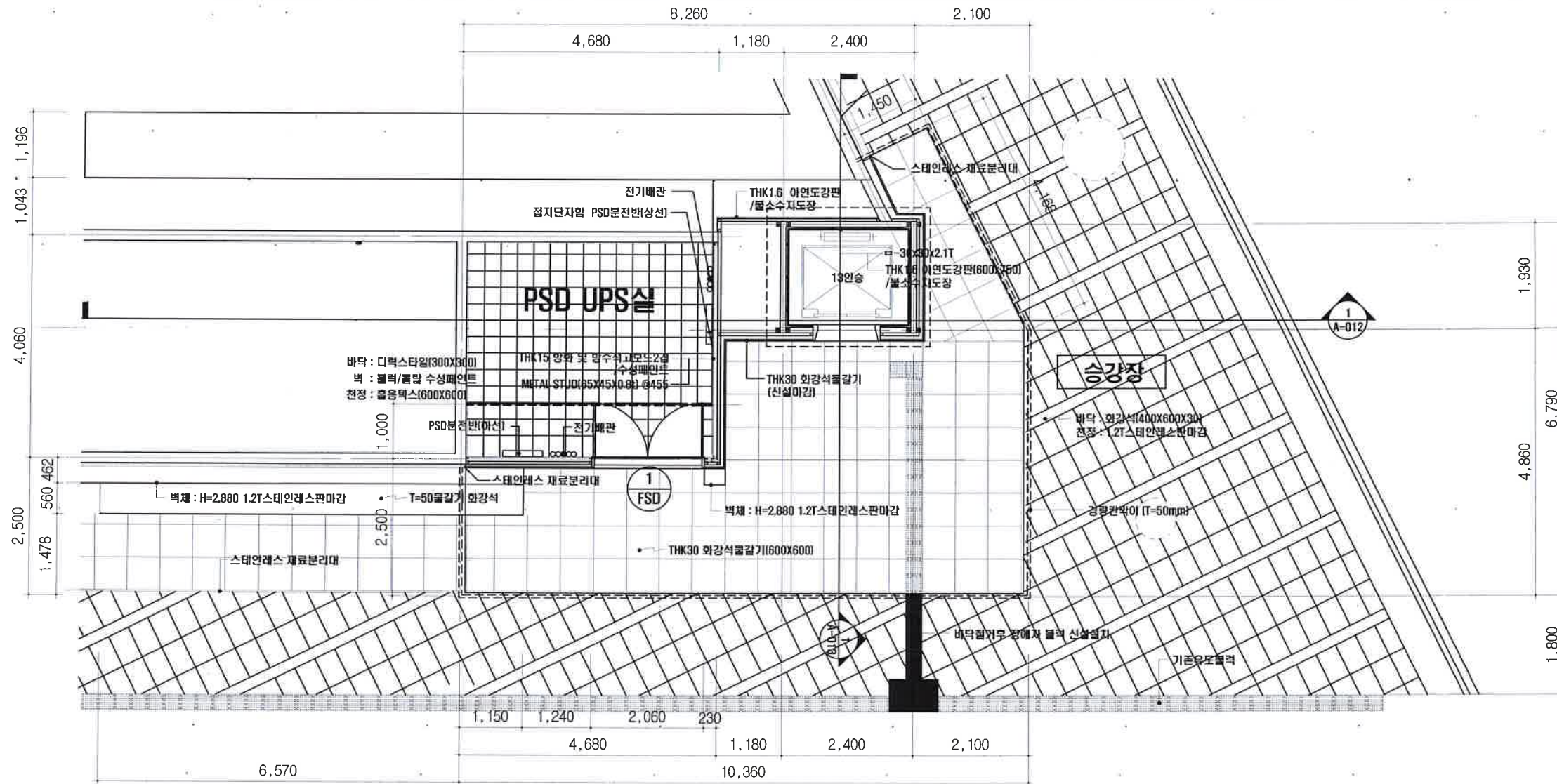

1 지하4층 평면도(변경후)
축척: 1/100

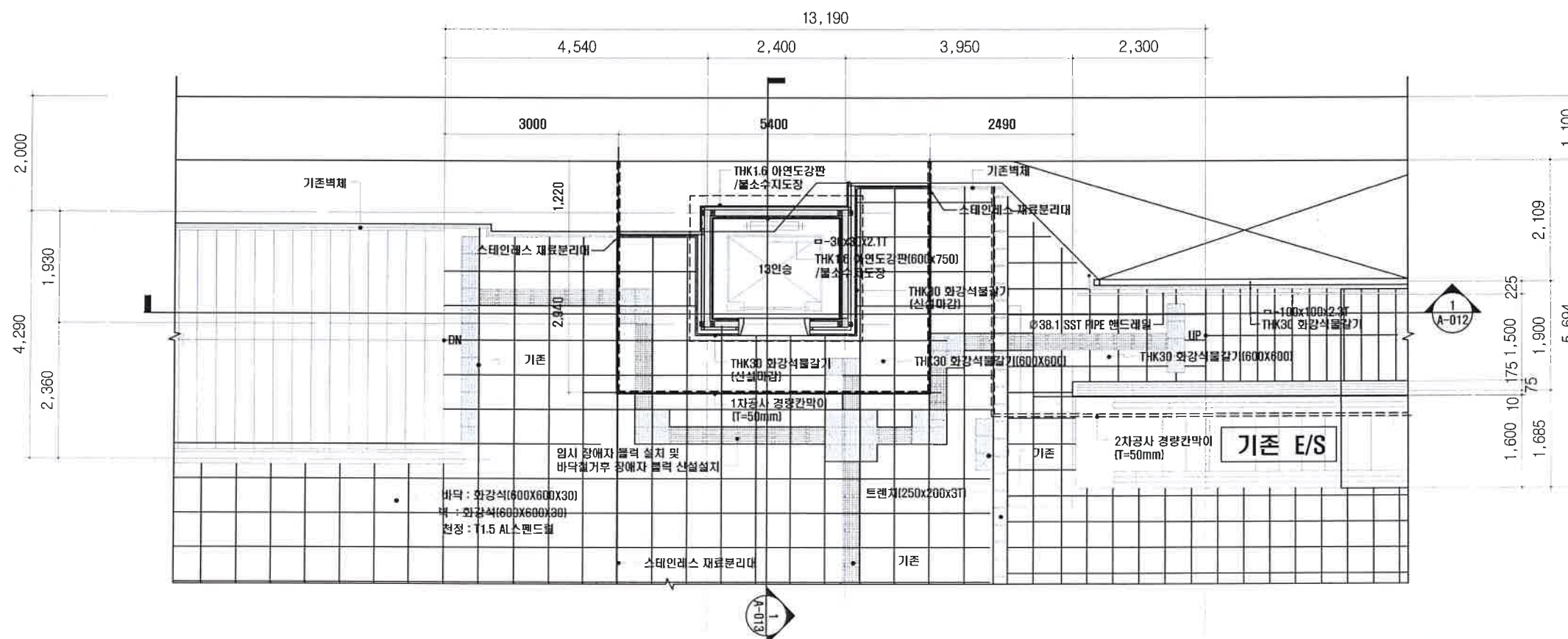

2 지하3층 평면도(변경후)
축척: 1/100

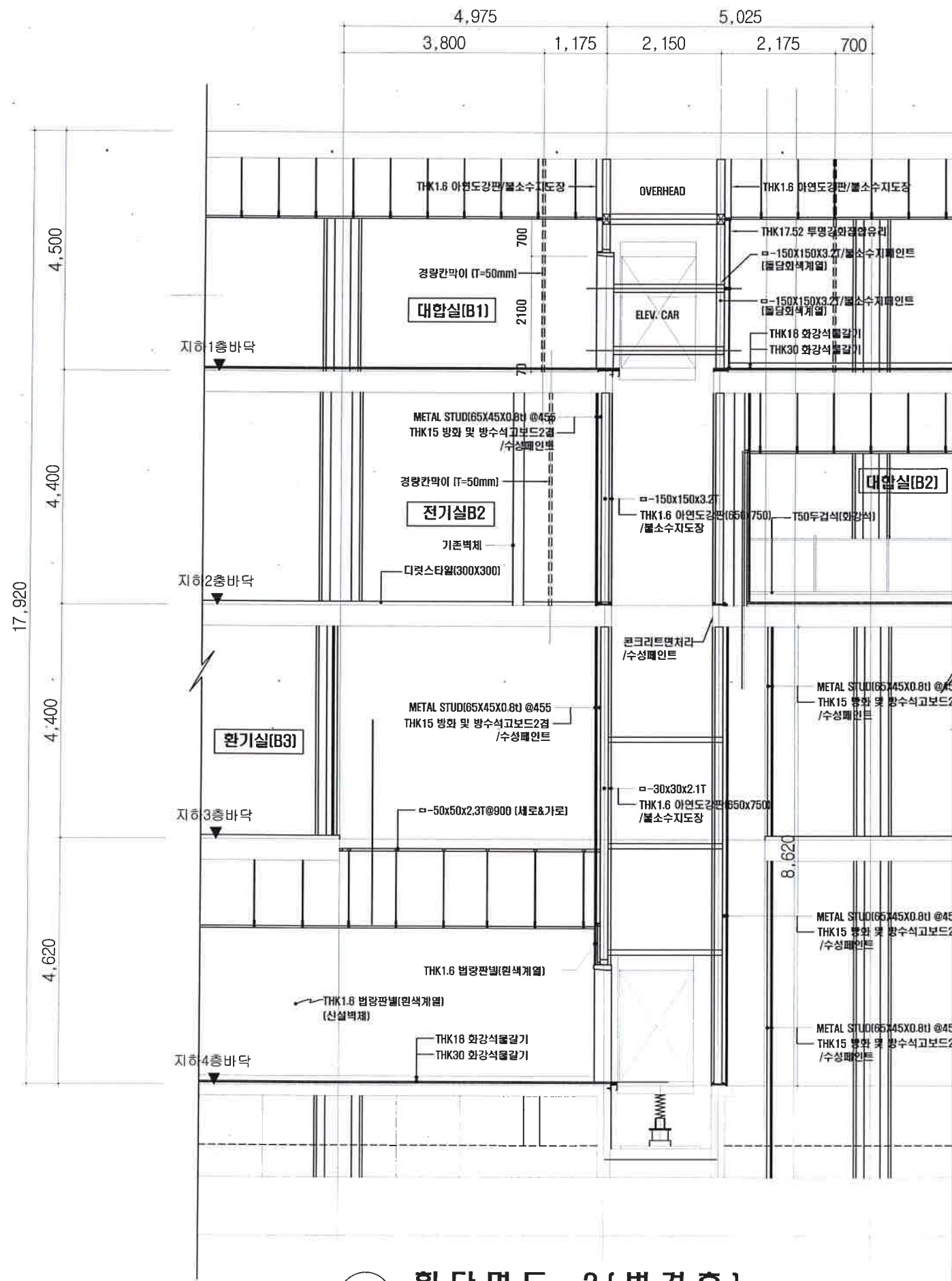

1
A-018
횡 단 면 도 - 2 (변경 후)
축척 : 1/100

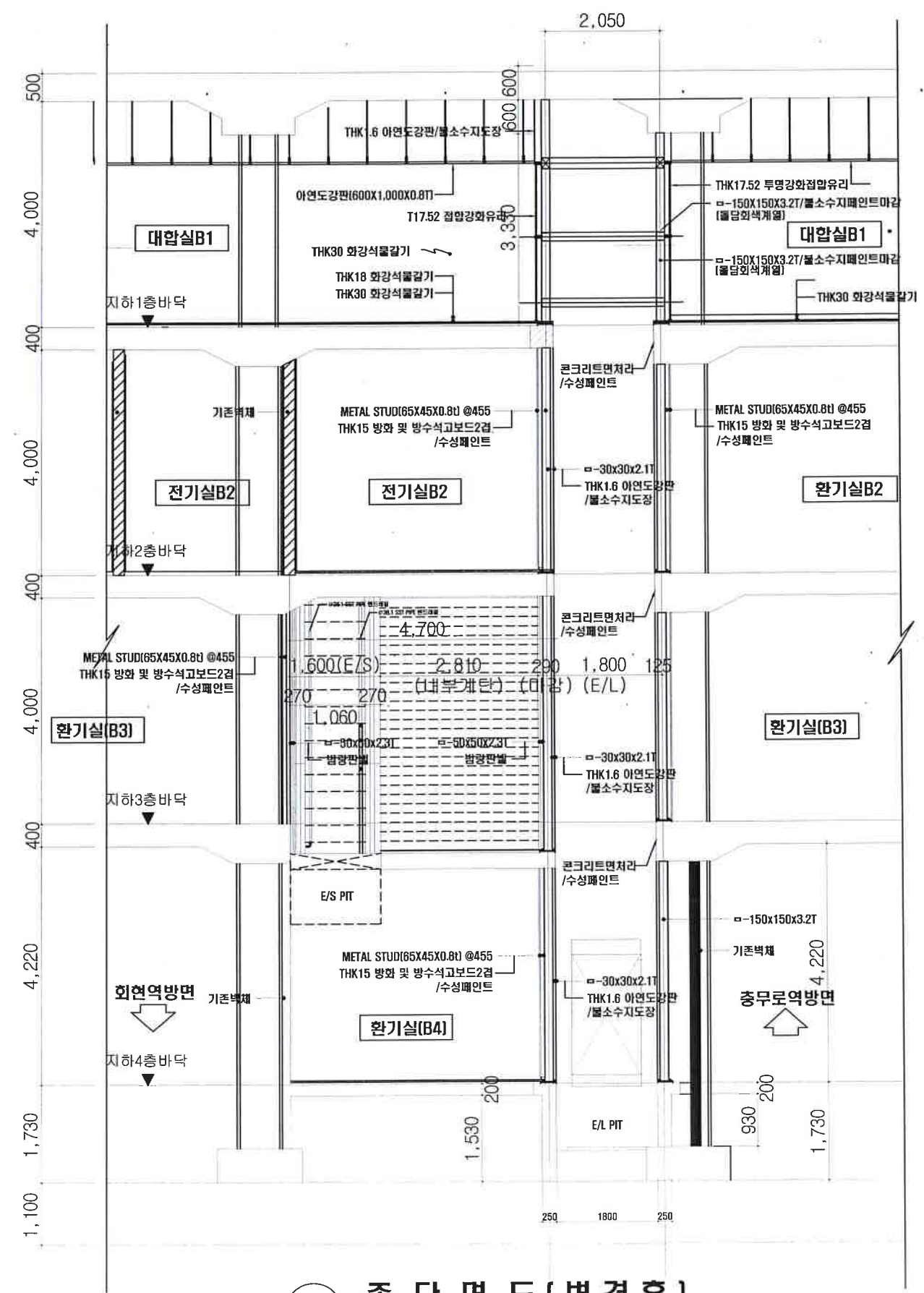

1
A-019
종 단 면 도 (변경 후)
축척 : 1/100

[범례]

기존부분
신설마감재 시공

KEY MAP

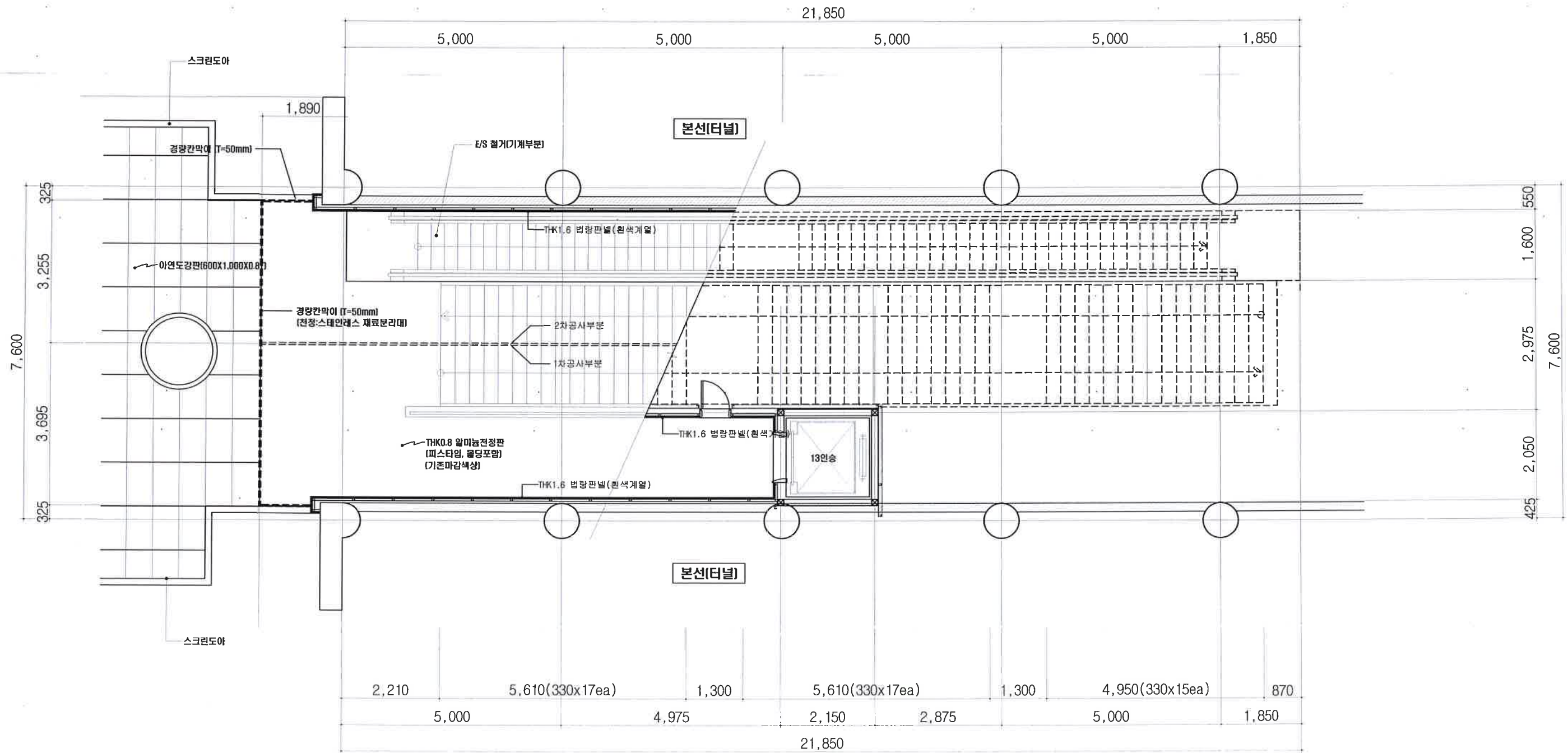
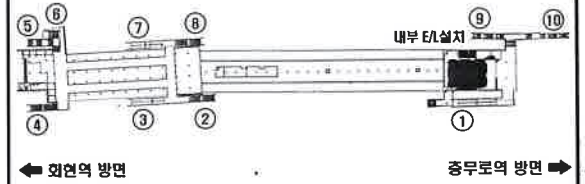

1 지하4층 천정 평면도
A-012 축척 : 1/100

